

**This electronic collection of documents is provided
for the convenience of the user
and is Not a Certified Document –**

**The documents contained herein were originally issued
and sealed by the individuals whose names and license
numbers appear on each page, on the dates appearing
with their signature on that page.**

**This file or an individual page
shall not be considered a certified document.**

STATE OF NORTH CAROLINA
DIVISION OF HIGHWAYS

PROJ. REFERENCE NO.	SHEET NO.
17BP.14.R.120	X-1A

Approximate quantities only. Unclassified excavation, borrow excavation, fine grading, clearing and grubbing, and removal of existing pavement will be paid for at the lump sum price for "Grading".

NOTE: EMBANKMENT COLUMN DOES NOT INCLUDE BACKFILL FOR UNDERCUT

CROSS-SECTION SUMMARY

Station	Uncl. Exc. (cu. yd.)	Embt (cu. yd.)																	
PHASE I																			
10+25.00	0	0																	
10+50.00	0	0																	
11+00.00	4	6																	
11+50.00	8	13																	
12+00.00	8	30																	
12+50.00	4	24																	
PHASE II																			
10+25.00	0	0																	
10+50.00	0	5																	
11+00.00	9	6																	
11+50.00	18	0																	
12+00.00	12	0																	
12+50.00	6	4																	
Y1																			
10+00.00	0	0																	
10+46.00	0	0																	
10+50.00	0	0																	
11+00.00	0	2																	
11+50.00	4	3																	
11+85.00	3	3																	

INDEX OF SHEETS	
-L-	X-1
-Y-	X-2 to X-4

8/23/99

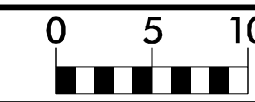

PROJ. REFERENCE NO.
17BP.14.R.120

SHEET NO.
X-1

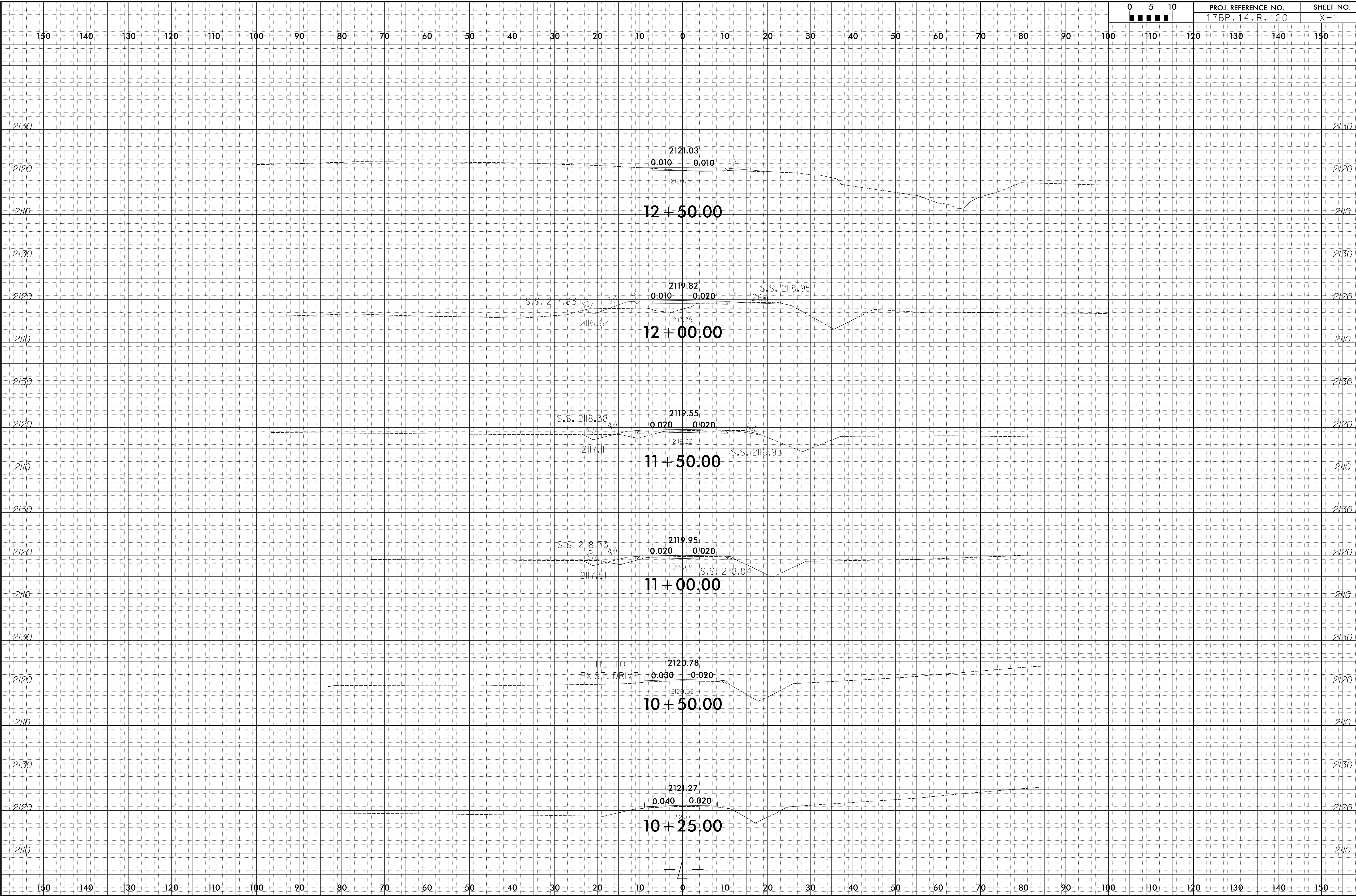

4/7/2016
 P:\2016\17BP.14.R.120\XSC\870163_Rdy_xpl.dgn
 2:10

150 140 130 120 110 100 90 80 70 60 50 40 30 20 10 0 10 20 30 40 50 60 70 80 90 100 110 120 130 140 150

8/23/99

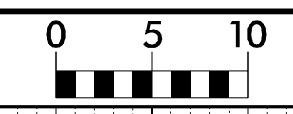

PROJ. REFERENCE NO.
17BP.14.R.120

SHEET NO.
X-2

150 140 130 120 110 100 90 80 70 60 50 40 30 20 10 0 10 20 30 40 50 60 70 80 90 100 110 120 130 140 150

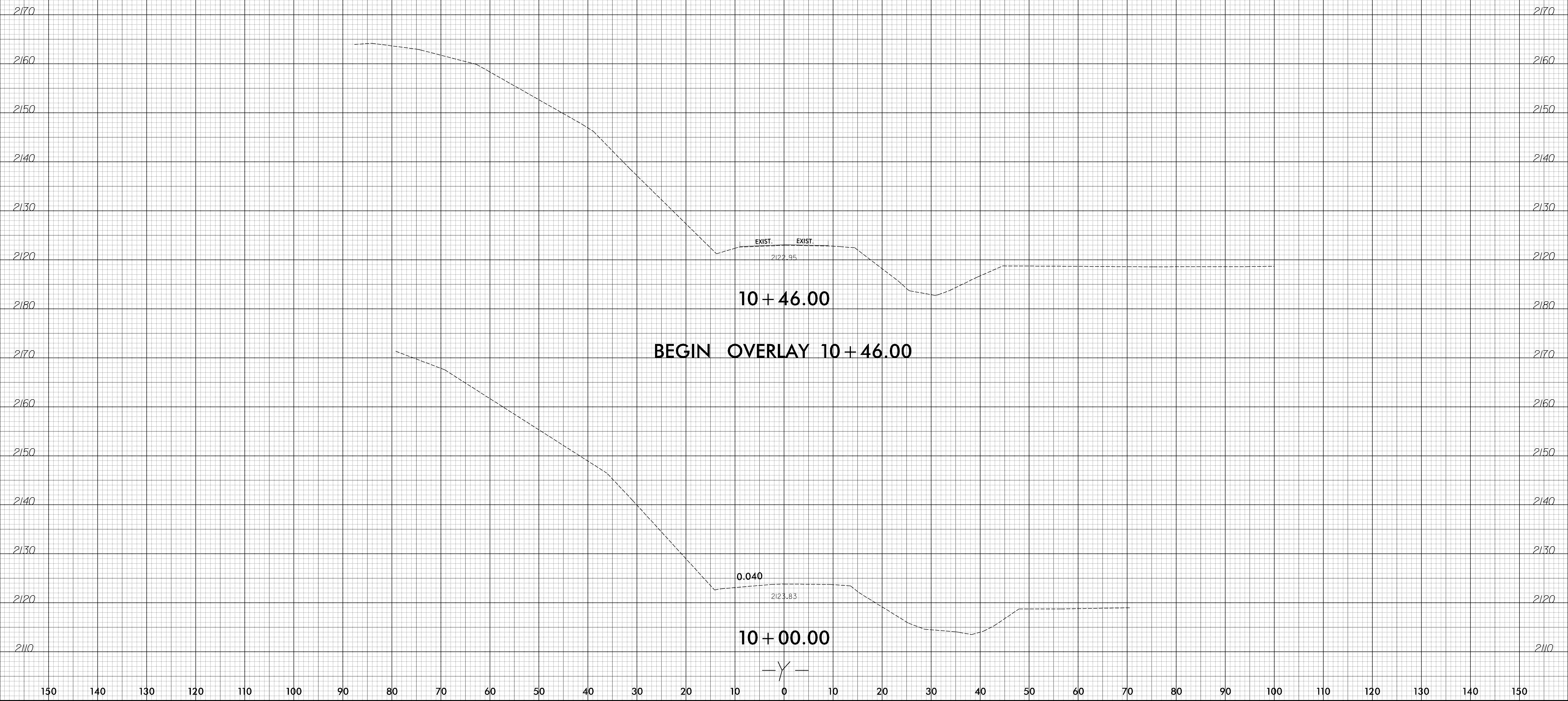

8/8/2014
F:\Projects\17BP.14.R.120\XSC\870163-Rdy_xpl.y.dgn
1:52:11 PM

8/23/99

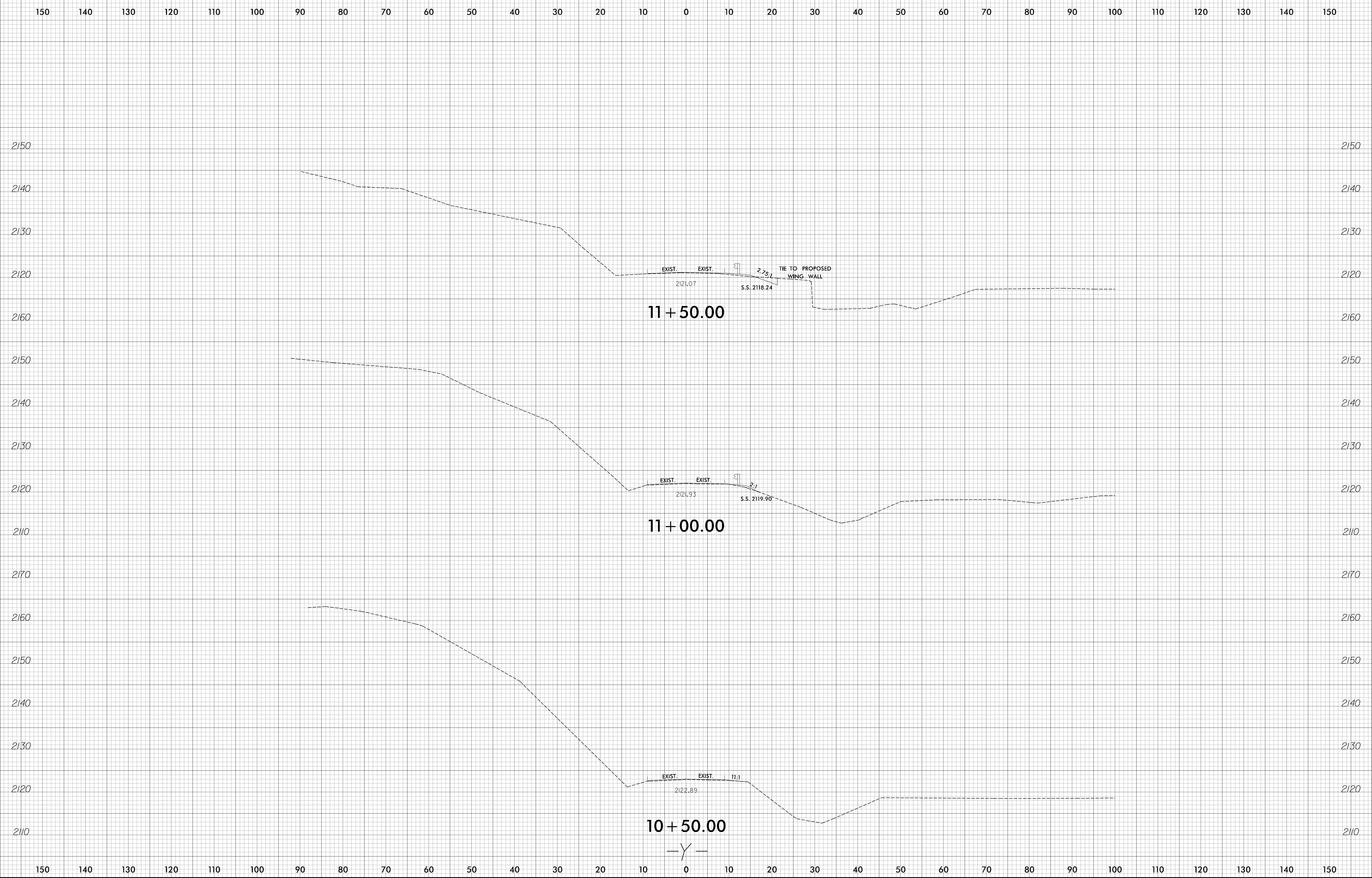

8/13/2014
D:\Projects\17BP.14.R.120\17BP.14.R.120.dgn

8/23/99

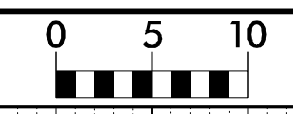

PROJ. REFERENCE NO.
17BP.14.R.120

SHEET NO.
X-4

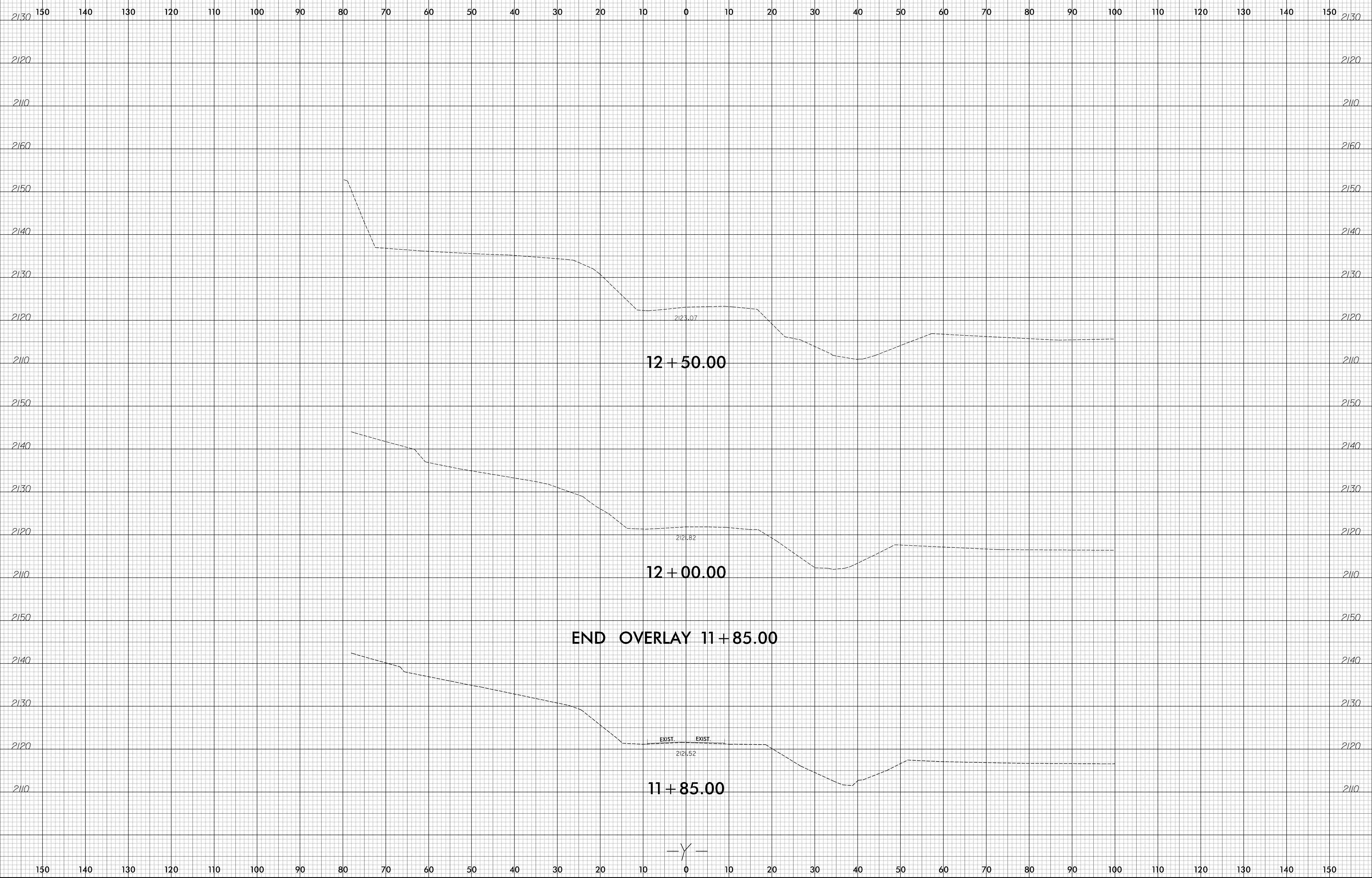

8/8/2014
F:\G99999999\XSC\870163.Rdy_xpl.y.dgn
11:17:18